

PVC-U SWING CHECK VALVES

VÁLVULAS DE CLAPETA PVC-U



Sizes	Metric flanges D63 - D315 (DN50 - DN300) ASTM flanges 4" - 12"	
Standards	ISO/DIN ASTM - 4" - 12"	EN 558-1 ANSI B.16.5 cl. 150
Working pressure	@ 20°C (73°F) D63 - D315 (2" - 12"): PN 6 (90 psi)	
Minimum return pressure	0,1 - 0,3 bar Minimal downstream pressure to keep the valve closed, depending on installation conditions. Presión mínima aguas abajo para mantener la válvula cerrada, dependiendo de las condiciones de instalación.	
Materials	O-rings: EPDM / FPM	
Characteristics	<ul style="list-style-type: none"> • Requires little space in piping systems. • Easy installation: wafer body slips between standard flanges. No gaskets required. • Vertical and horizontal operation. • Excellent flow characteristics. <p>Do not install the valve at a distance lower than 5 x D of the pump out. Install with pipe DIN PN 10 (SCH40). In case of PN 16 (SCH80), the valve could be damaged.</p>	<ul style="list-style-type: none"> • Requiere poco espacio en la instalación. • Fácil instalación: se monta entre bridas standard. Sin necesidad de juntas adicionales. • Instalación vertical y horizontal. • Excelentes características de conducción. <p>No montar la válvula a una distancia inferior a 5 x D de la salida de una bomba. Montar con tubo PN 10 (SCH40). En caso de usar un PN 16 (SCH80) se podrían ocasionar daños en la válvula.</p>
Certifications / regulations	Check valve design regulation - ISO 16137:2006	

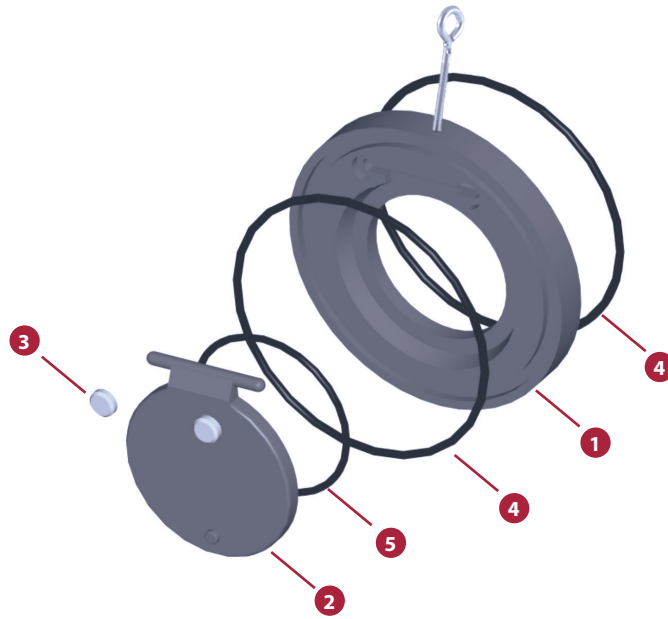
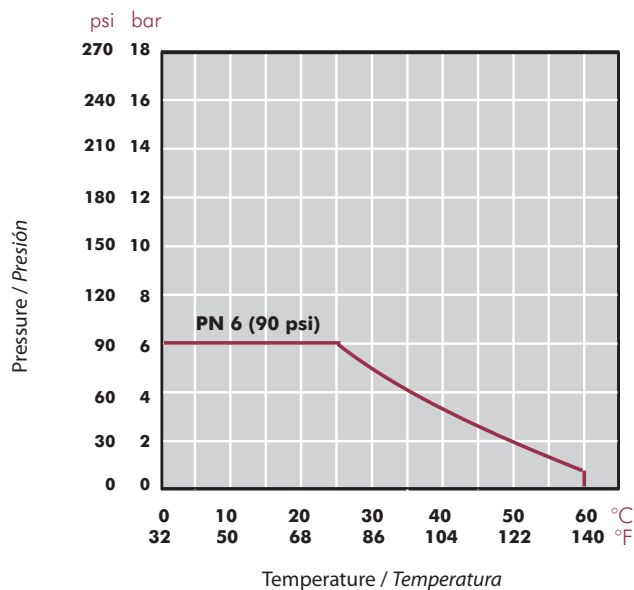

FIG.	Parts	Despiece	Material
1	Body	Cuerpo	PVC-U
2	Flap	Clapeta	PVC-U
3	Cap	Tapón	PP
4	Body O-ring	Junta cuerpo	EPDM / FPM
5	Flap O-ring	Junta clapeta	EPDM / FPM

PRESSURE / TEMPERATURE GRAPH
DIAGRAMA PRESIÓN / TEMPERATURA



Life: 25 years
 Hydrostatic maximum pressure a component may withstand in continuous service (without overpressure)

Vida útil: 25 años
Presión hidrostática máxima que un componente es capaz de soportar en servicio continuo (sin sobrepresión)

PRESSURE LOSS DIAGRAM

DIAGRAMA DE PÉRDIDAS DE CARGA

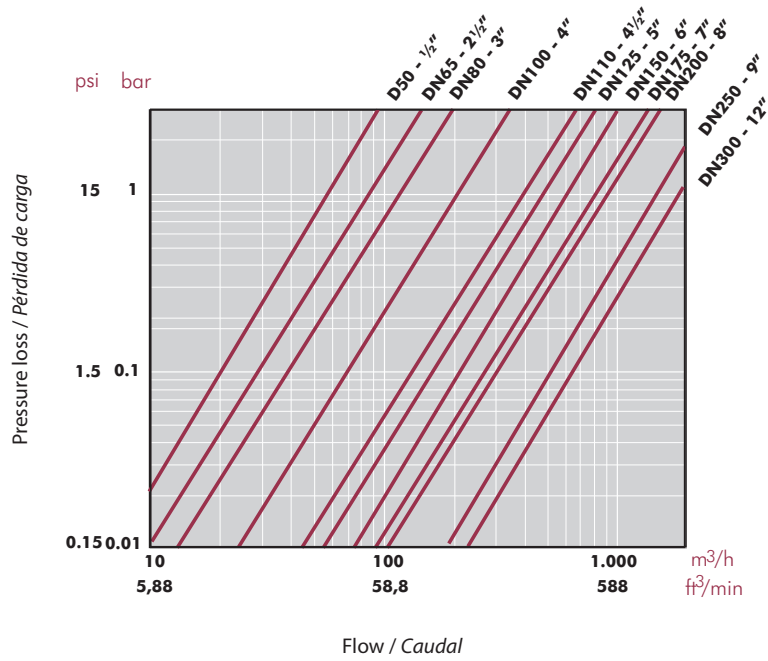

RELATIVE FLOW
FLUJO RELATIVO

D	63	75	90	110	125	140	160	200	225	250	280	315
DN	50	65	80	100	125	125	150	175	200	250	250	300
Kv ₁₀₀ (m³/h)	57	85	130	200	390	480	600	800	900	1.600	1.600	1.850
Kv ₁₀₀ (l/min)	950	1.417	2.167	3.333	6.500	8.000	10.000	13.333	15.000	26.667	26.667	30.833
Cv	67	99	152	233	455	560	700	934	1.050	1.867	1.867	2.159

Cv = Kv₁₀₀ / 14,28
Kv₁₀₀ (l/min, Δp = 1 bar)
Cv (GPM, Δp = 1 psi)

UP. 65 - SWING CHECK VALVE

Swing check valve

- PVC-U body
- O-rings in EPDM

Válvula de clapeta

- Cuerpo en PVC-U
- Anillos tóricos en EPDM

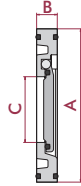
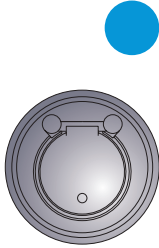

D	DN	PN	REF.	CODE
63	50	6	05 65 063 *	37055
75	65	6	05 65 075	08984
90	80	6	05 65 090	08985
110	100	6	05 65 110	08986
125	125	6	05 65 125	09040
140	125	6	05 65 140	08987
160	150	6	05 65 160	08988
200	175	6	05 65 200	09041
225	200	6	05 65 225	08989
250	250	6	05 65 250	37056
280	250	6	05 65 280 *	41865
315	300	6	05 65 315 *	37057

A	B	C
109	20	32
129	20	40
144	20	52
164	22	70
170	25	83
195	23	92
220	25	112
247	28	139
275	35	150
328	40	162
330	40	189
380	45	226

UP. 65. FG - SWING CHECK VALVE

Swing check valve

- PVC-U body
- O-rings in EPDM perox.

Válvula de clapeta

- Cuerpo en PVC-U
- Anillos tóricos en EPDM perox.

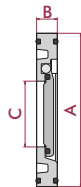
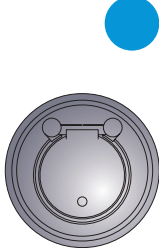

D	DN	PN	REF.	CODE
63	50	6	05 65 063 FG *	37055FG
75	65	6	05 65 075 FG	08984FG
90	80	6	05 65 090 FG	08985FG
110	100	6	05 65 110 FG	08986FG
125	125	6	05 65 125 FG	09040FG
140	125	6	05 65 140 FG	08987FG
160	150	6	05 65 160 FG	08988FG
200	175	6	05 65 200 FG	09041FG
225	200	6	05 65 225 FG	08989FG
250	250	6	05 65 250 FG	37056FG
280	250	6	05 65 280 FG*	41865FG
315	300	6	05 65 315 FG*	37057FG

A	B	C
109	20	32
129	20	40
144	20	52
164	22	70
170	25	83
195	23	92
220	25	112
247	28	139
275	35	150
328	40	162
330	40	189
380	45	226

UP. 65. VIT - SWING CHECK VALVE

Swing check valve

- PVC-U body
- O-rings in FPM

Válvula de clapeta

- Cuerpo en PVC-U
- Anillos tóricos en FPM

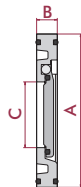
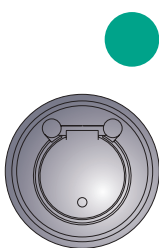

D	DN	PN	REF.	CODE
63	50	6	05 65 063 VIT*	37055VI
75	65	6	05 65 075 VIT	08984VI
90	80	6	05 65 090 VIT	08985VI
110	100	6	05 65 110 VIT	08986VI
125	125	6	05 65 125 VIT	09040VI
140	125	6	05 65 140 VIT	08987VI
160	150	6	05 65 160 VIT	08988VI
200	175	6	05 65 200 VIT	09041VI
225	200	6	05 65 225 VIT	08989VI
250	250	6	05 65 250 VIT	37056VI
280	250	6	05 65 280 VIT*	41865VI
315	300	6	05 65 315 VIT*	37057VI

A	B	C
109	20	32
129	20	40
144	20	52
164	22	70
170	25	83
195	23	92
220	25	112
247	28	139
275	35	150
328	40	162
330	40	189
380	45	226

UP. 65. VKIT - SWING CHECK VALVE KIT

Swing check valve with mounting kit

- PVC-U body
- O-rings in EPDM
- Loose flanges

Válvula de clapeta con kit accesorios

- Cuerpo en PVC-U
- Anillos tóricos en EPDM
- Bridas locas

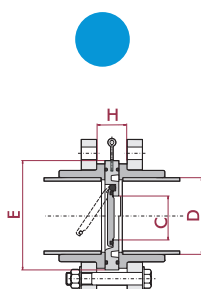

D	DN	PN	REF.	CODE
63	50	6	05 65 063 RA *	37073
75	65	6	05 65 075 RA	23312
90	80	6	05 65 090 RA	23313
110	100	6	05 65 110 RA	23314
125	125	6	05 65 125 RA	23315
140	125	6	05 65 140 RA	23316
160	150	6	05 65 160 RA	23317
200	175	6	05 65 200 RA	23318
225	200	6	05 65 225 RA	23319
250	250	6	05 65 250 RA	37074
315	300	6	05 65 315 RA *	37075

C	H	E
32	26	109
40	30	129
52	30	144
70	32	164
83	35	170
92	33	195
112	37	220
139	40	247
150	51	275
162	56	328
226	64	330